

Operating Instructions and parts list

2 Ton Capacity

FOLDING HYDRAULIC SHOP CRANE

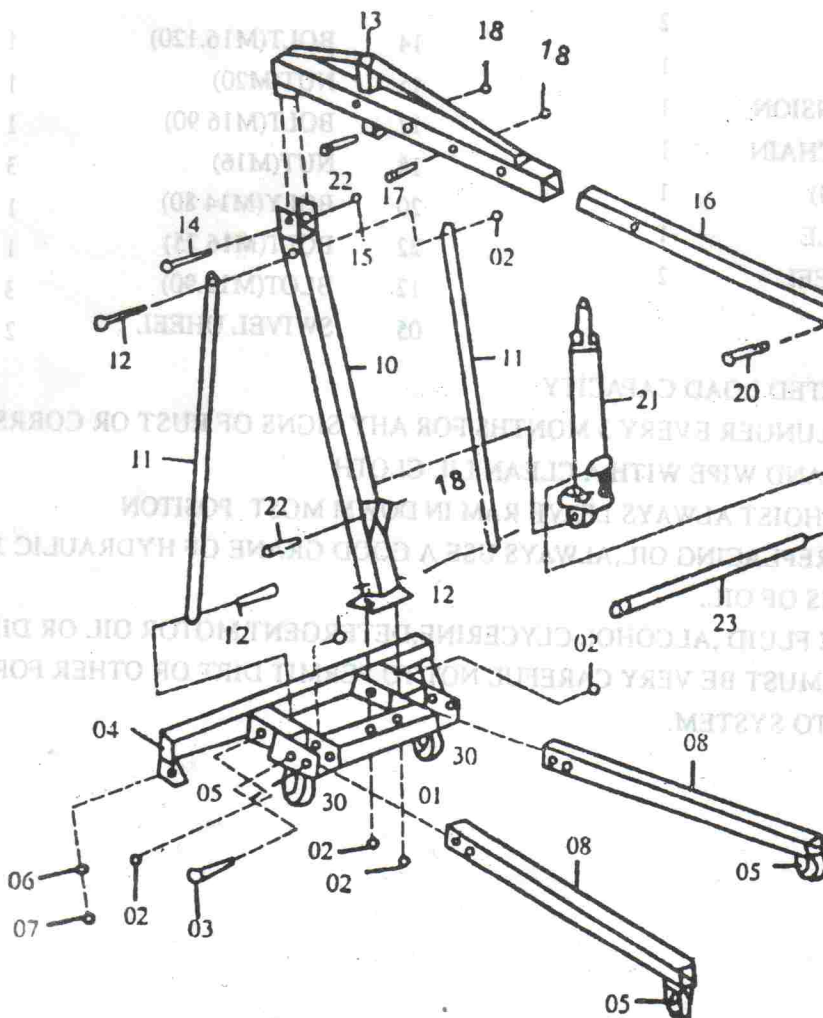

FOR YOUR SAFETY

please read these instructions carefully and retain them for future use.

IMPORTANT NOTE

SOME TIMES,DURING SHIPMENT AND HANDING,AIR GETS INTO THE HYDRAULIC SYSTEM CAUSING POOR LIFTING PERFORMANCE,PURGE AHY AIR FROM SYSTEM BY FULL OPENING RELEASE VALVE(TURN VALVE COUNTERCLOCKWISE) WHILE HOLDING END OF RAM CYLINDER DOWN,OPERATE PUMP HANDLE RAPIDLY SEVERAL TIME.

PARTS LIST

REF	DESCRIPTION	QTY
01	BASE	1
08	BASEEXTENSIONS	2
10	POST	1
11	SUPPORTS	2
13	BOOM	1
16	BOOMEXTENSION	1
19	HOOK AND CHAIN	1
21	JACK(8000KG)	1
23	JACK HANDLE	1
30	SWIVEL WHEEL	2

HARDWARELIST

REF	DESCRIPTION	QTY
02	NUT(M14)	6
03	PIN(M16.110)	4
14	BOLT(M16.120)	1
15	NUT(M20)	1
17	BOLT(M16 90)	1
18	NUT(M16)	3
20	BOLY(M14 80)	1
22	BOLT(M16 75)	1
12	BLOT(M12.90)	3
05	SWIVEL UHEEL	2

DO NOT EXCEED RATED LOAD CAPACITY

CHECK RAM AND PLUNGER EVERY 3 MONTHS FOR AHY SIGNS OF RUST OR CORRSION

CLEAN AS NEEDED AND WIPE WITH A CLEAN LIL CLOTH

WHEN NOT USEING,HOIST ALWAYS LEAVE RAM IN DOWM MOST POSITON

WHEN ADDING OR REPLACING OIL,ALWAYS USE A GOOD GRANE OF HYDRAULIC JACK OIL, AVOID MIXINGTYPES OF OIL.

DO NOT USE BRAKE FLUID ,ALCOHOL,CLYCKERINE,DETERGENT,MOTOR OIL OR DIRTY OIL.

WHEN ADDING OIL,MUST BE VERY CAREFUL NOT TO PERMIT DIRT OR OTHER FOR EIGN MATTER TO GET INTO SYSTEM.